

CONTACT
CONFIGURATION
(BCR FACE VIEWS)

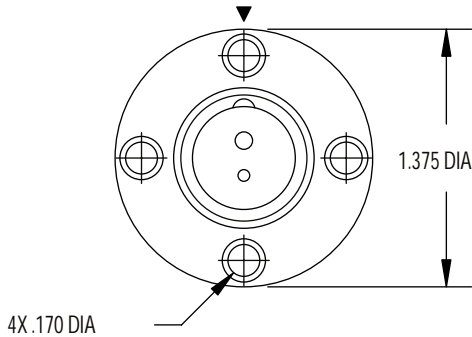

4X .170 DIA

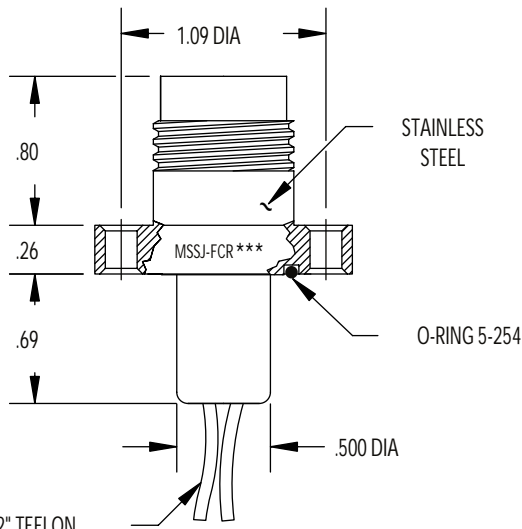

12" TEFLON
LEADS ****

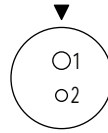

1#14
1#16

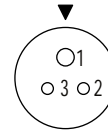

1#14
2#16

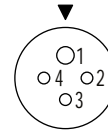

1#14
3#16

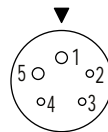

2#16
3#20

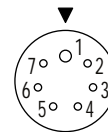

1#16
6#20

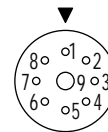

1#14
8#20

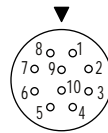

10#20

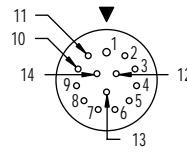

1#20
13#22

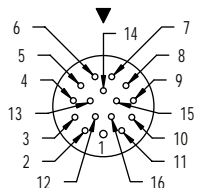

1#20
15#22

NOTE: Not available in OF.

MOUNTING TORQUE FOR MSSJ, MSAJ-BCR	not to exceed 100 in/lbs	MATED PRESSURE RATING (psi)	10,000
DUMMY PLUG FOR MSSJ-BCR/FCR/CCR	MSSJ-* -SCP	DUMMY PLUG FOR MSSJ-CCP, MSAJ-CCP	MSJ-SCR (Epoxy)
DUMMY PLUG FOR MSAJ-BCR/CCR	MSAJ-* -SCP		

NOTE: CCP is not terminated to cable unless specified.
Nylon engaging nut used with aluminum body.
* Please specify number of contacts.
** Extended backshell for Oil Filled assemblies.
*** Internal assembly same as MSSJ/MSAJ-BCR (facing page).
**** Solder cup version available.

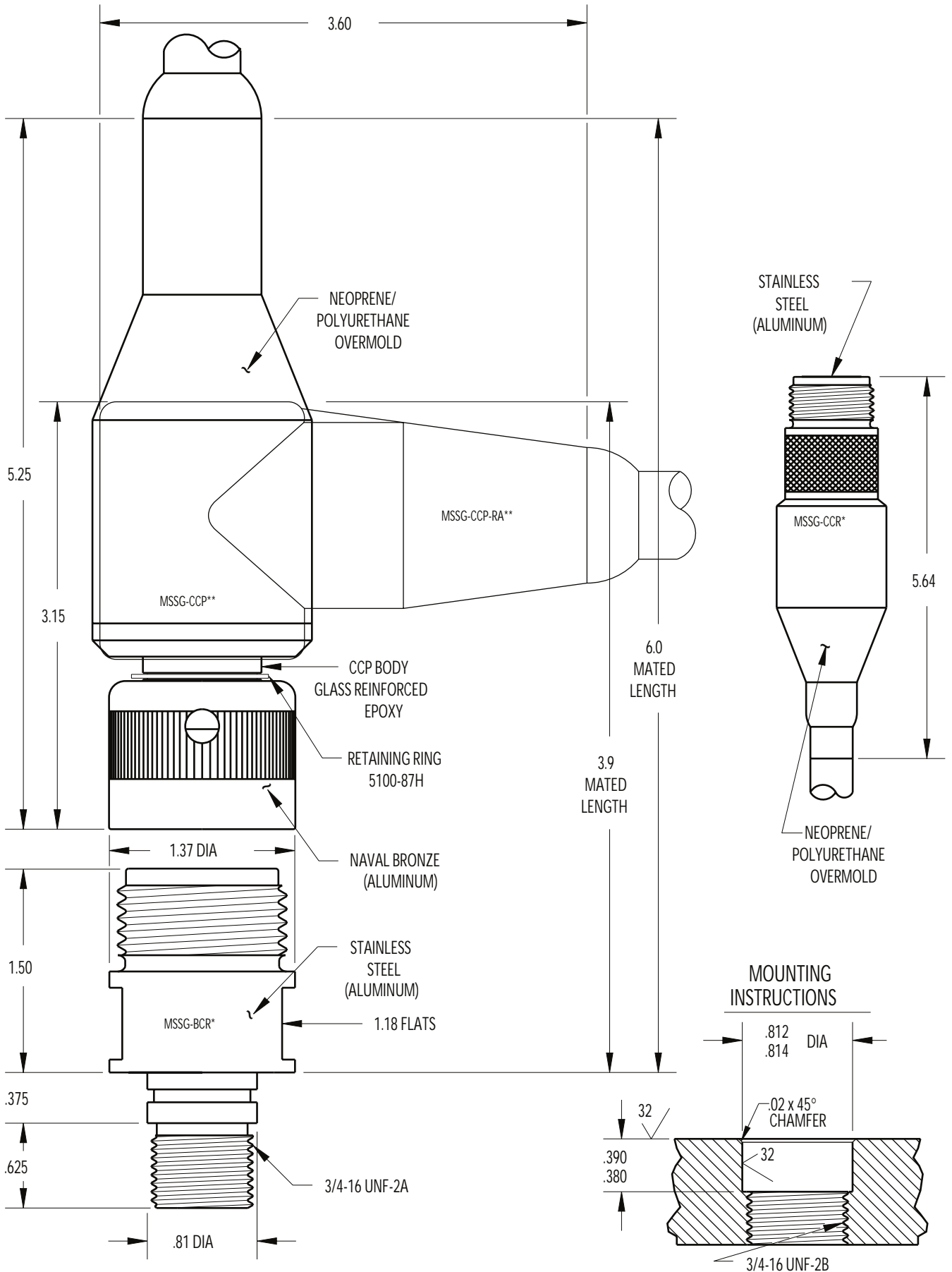

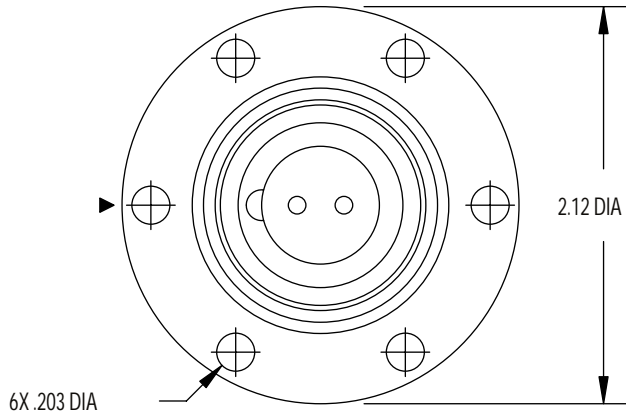

CONTACT CONFIGURATION
(BCR FACE VIEWS)

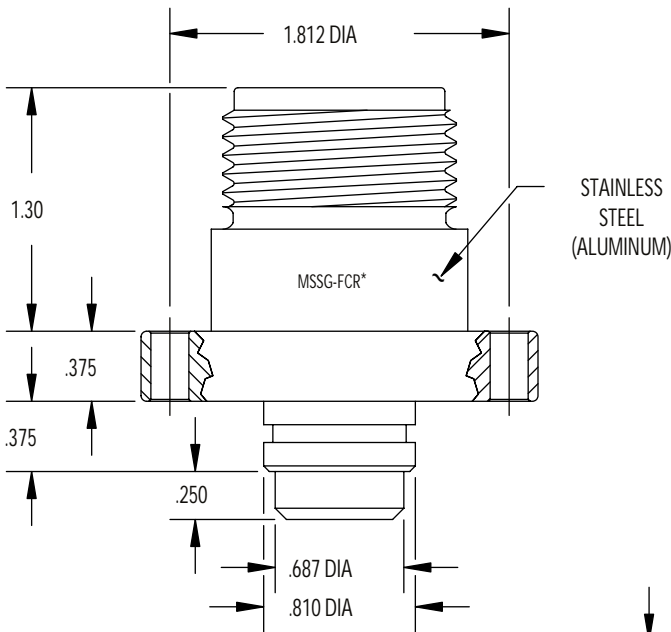
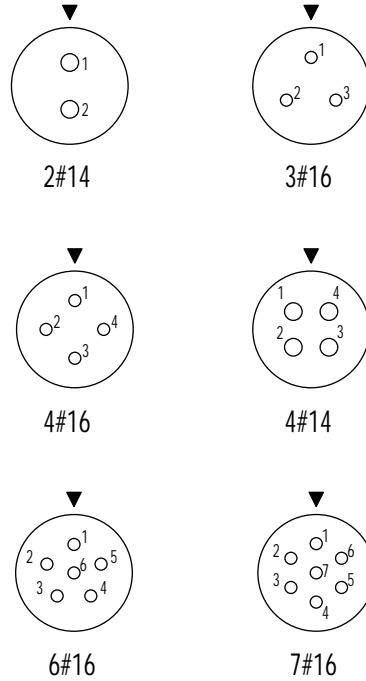

MOUNTING INSTRUCTIONS

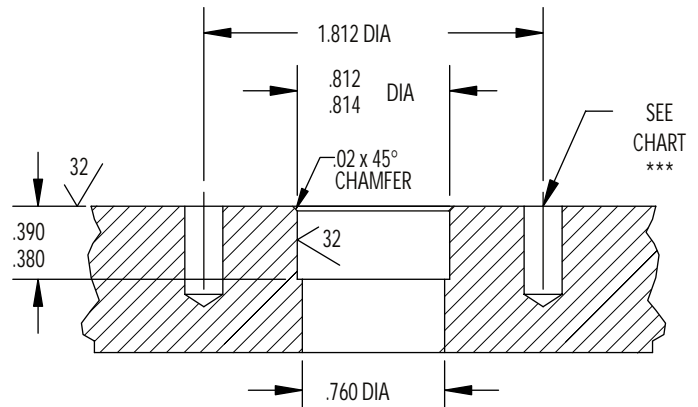

MOUNTING TORQUE FOR MSSG, MSAG-BCR	not to exceed 200 in/lbs	MATED PRESSURE RATING (psi)	20,000
DUMMY PLUG FOR MSSG-BCR/FCR/CCR	MSSG-SCP	DUMMY PLUG FOR MSSG-CCP	MSSG-SCR
DUMMY PLUG FOR MSAG-BCR/FCR/CCR	MSAG-SCP	DUMMY PLUG FOR MSAG-CCP	MSAG-SCR

NOTE: Delrin protective caps available upon request.
 * See Technical Bulletin 45 71 for internal assembly and hardware specifications.
 ** See Technical Bulletin 45 72 for internal assembly and hardware specifications.
 *** Blind tapped hole not to penetrate bulkhead, minimum full thread depth 2 times bolt diameter.

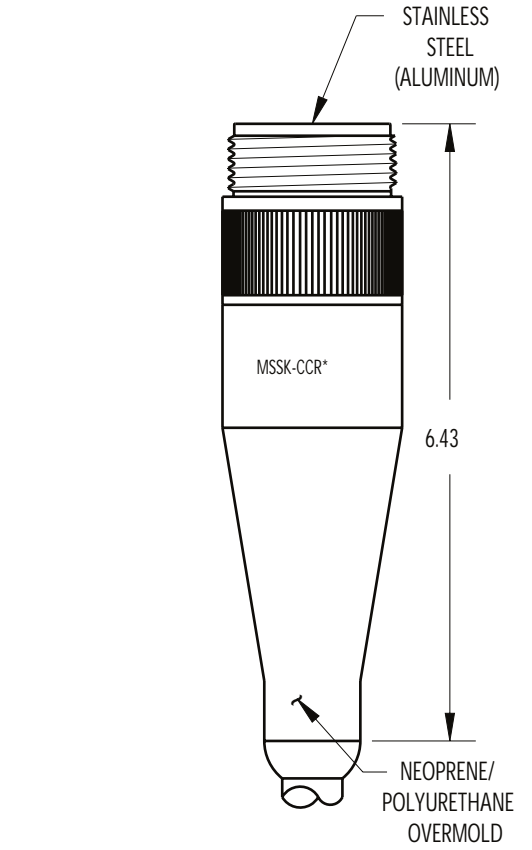
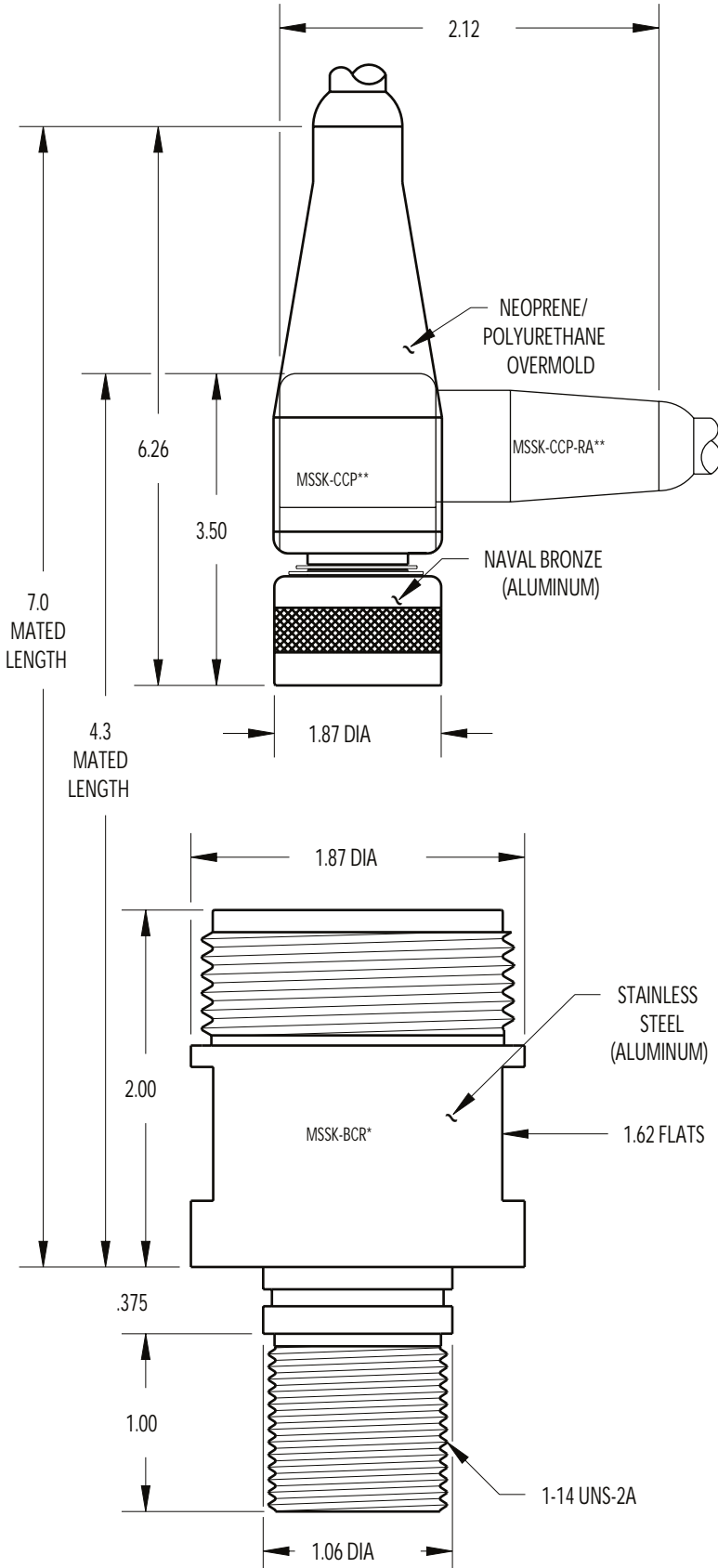

MOUNTING INSTRUCTIONS

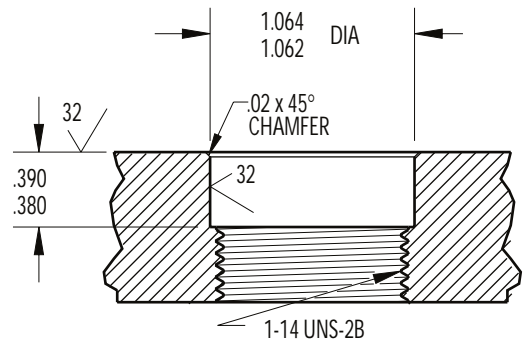

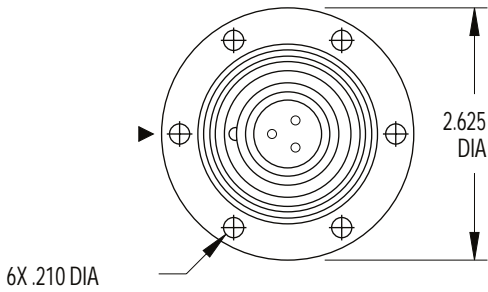

CONTACT
CONFIGURATION
(BCR FACE VIEWS)

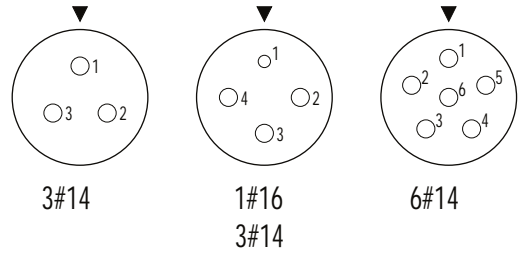

3#14

1#16
3#14

6#14

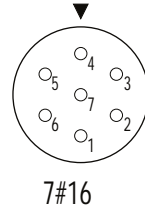
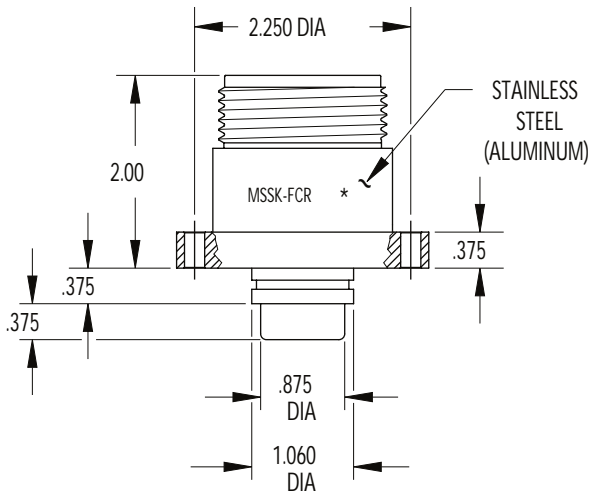

7#16

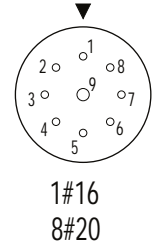

1#16
8#20

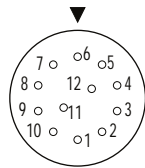

12#20

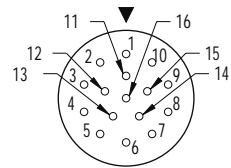

16#20

MOUNTING INSTRUCTIONS

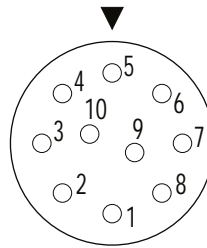
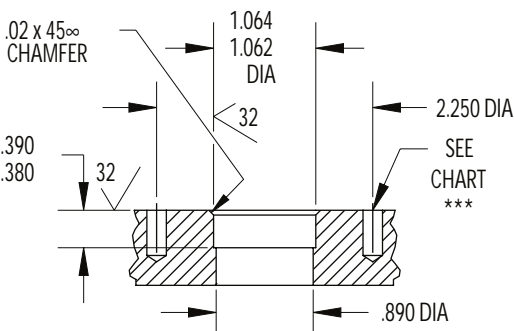

10#16 IE

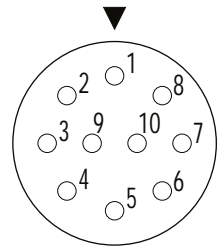

10#16 NAVY

NOTE: Please specify Navy or IE pin configuration when ordering.

MOUNTING TORQUE FOR MSSK, MSAK-BCR	not to exceed 200 in/lbs	MATED PRESSURE RATING (psi)	20,000
DUMMY PLUG FOR MSSK-BCR/FCR/CCR	MSSK-SCP	DUMMY PLUG FOR MSSK-CCP	MSSK-SCR
DUMMY PLUG FOR MSAK-BCR/FCR/CCR	MSAK-SCP	DUMMY PLUG FOR MSAK-CCP	MSAK-SCR

NOTE: Delrin protective caps available upon request.
 * See Technical Bulletin 45 71 for internal assembly and hardware specifications.
 ** See Technical Bulletin 45 72 for internal assembly and hardware specifications.
 *** Blind tapped hole not to penetrate bulkhead, minimum full thread depth 2 times bolt diameter.

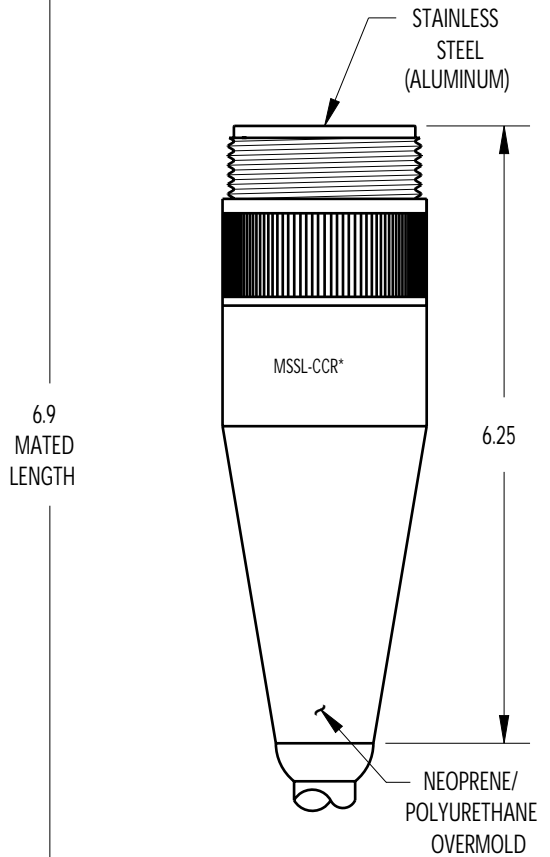
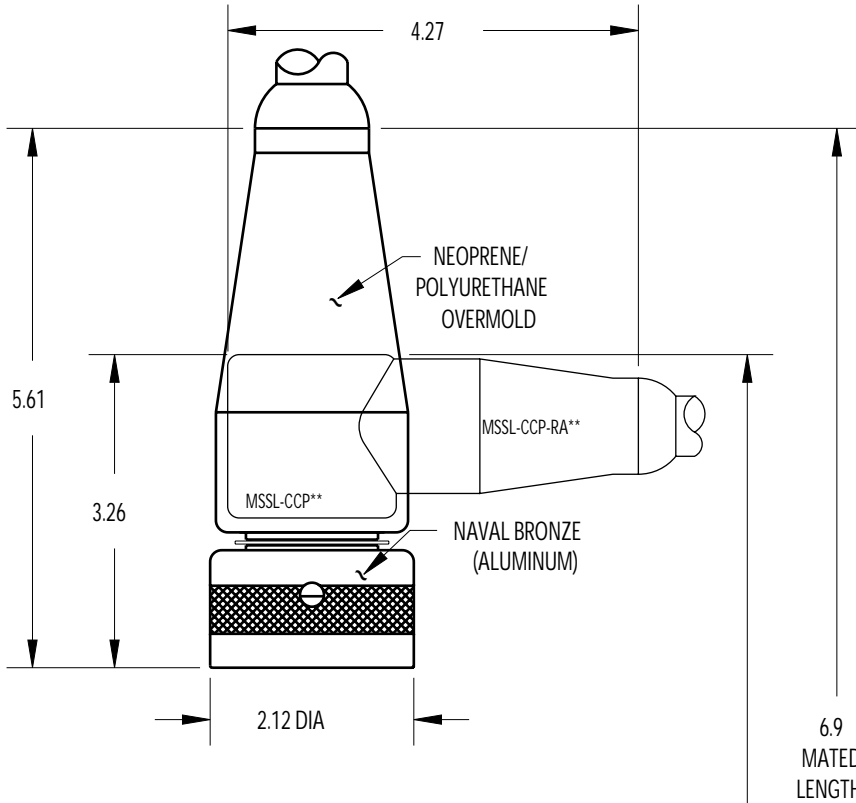

SCALE 1:2

MOUNTING
INSTRUCTIONS

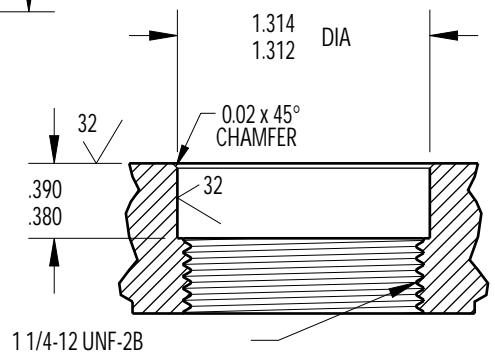
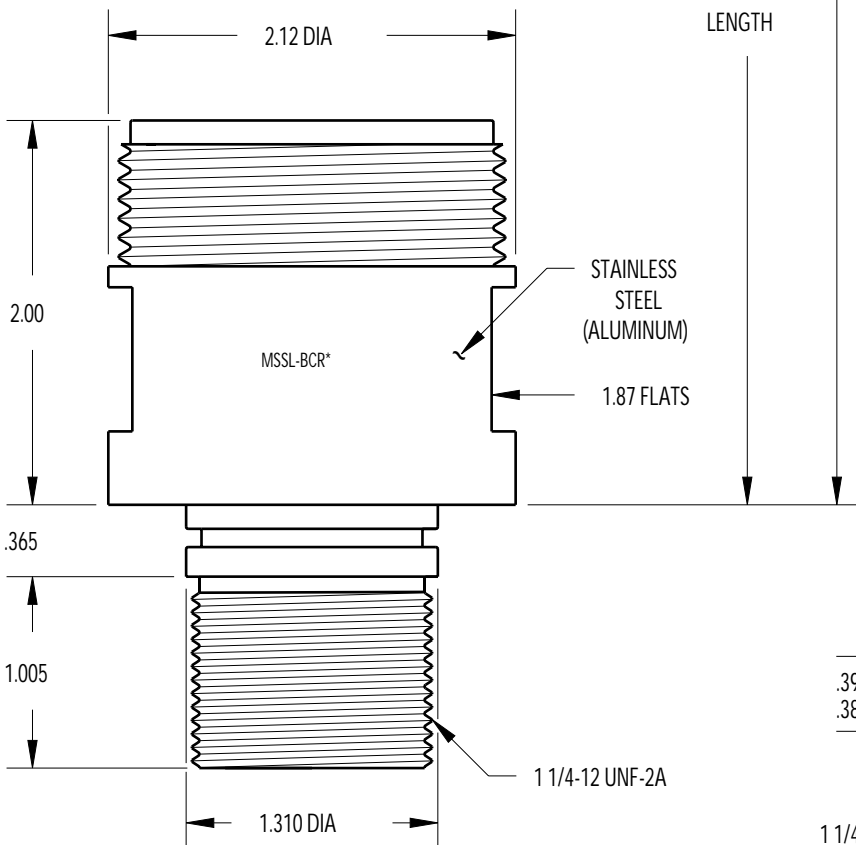

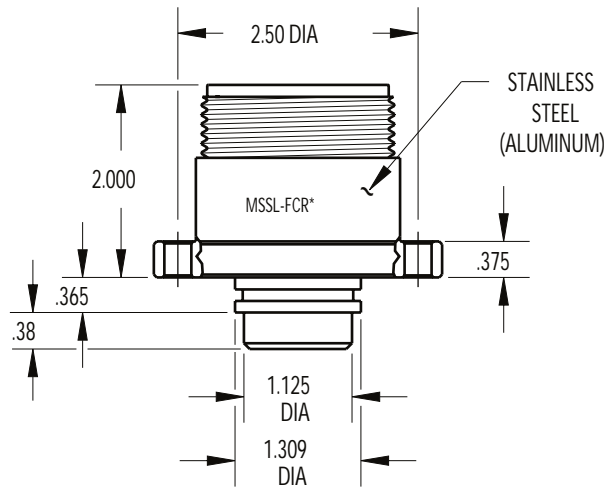
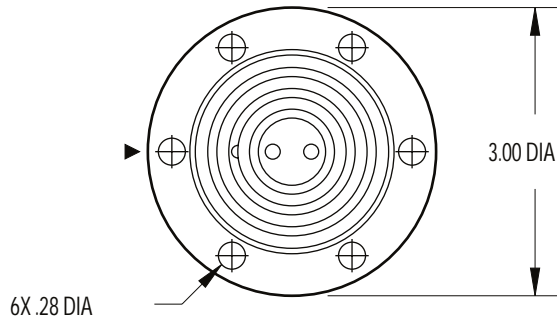

MOUNTING INSTRUCTIONS

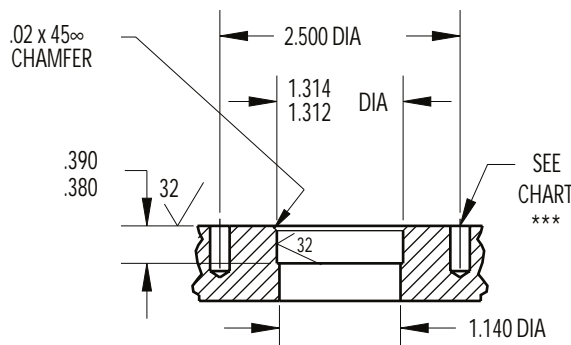

MOUNTING TORQUE FOR MSSL, MSAL-BCR	not to exceed 200 in/lbs	MATED PRESSURE RATING (psi)	20,000
DUMMY PLUG FOR MSSL-BCR/FCR/CCR	MSSL-SCP	DUMMY PLUG FOR MSSL-CCP	MSSL-SCR
DUMMY PLUG FOR MSAL-BCR/FCR/CCR	MSAL-SCP	DUMMY PLUG FOR MSAL-CCP	MSAL-SCR

NOTE: Delrin protective caps available upon request.

* See Technical Bulletin 45 71 for internal assembly and hardware specifications.

** See Technical Bulletin 45 72 for internal assembly and hardware specifications.

*** Blind tapped hole not to penetrate bulkhead, minimum full thread depth 2 times bolt diameter.

CONTACT
CONFIGURATION
(BCR FACE VIEWS)

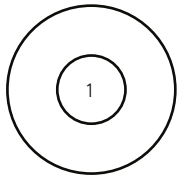

1#1/0

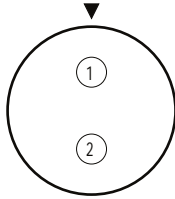

2#8

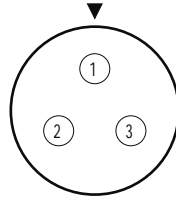

3#8

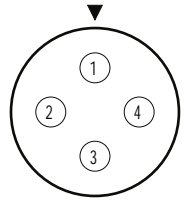

4#8 *

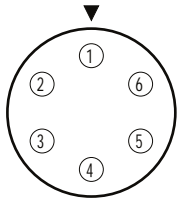

6#10

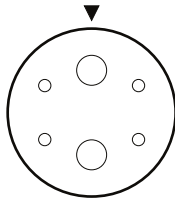

2#8
4#16

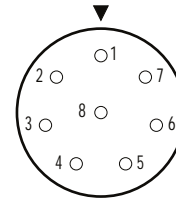

8#16

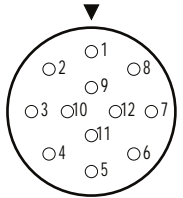

12#16

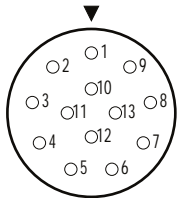

13#16

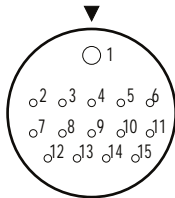

1#16
14#20

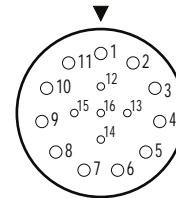

5#20
11#16

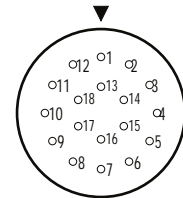

18#20

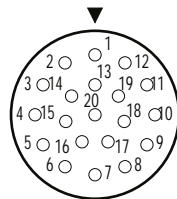

20#16

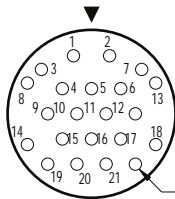

22#16

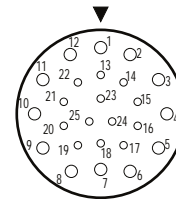

12#16
13#20

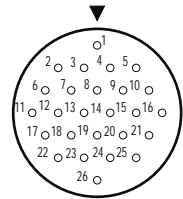

26#20

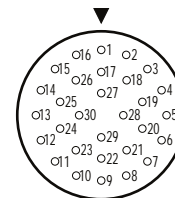

30#20

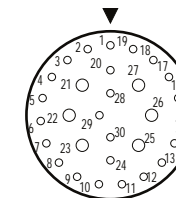

6#16
24#20

* Available in high voltage.

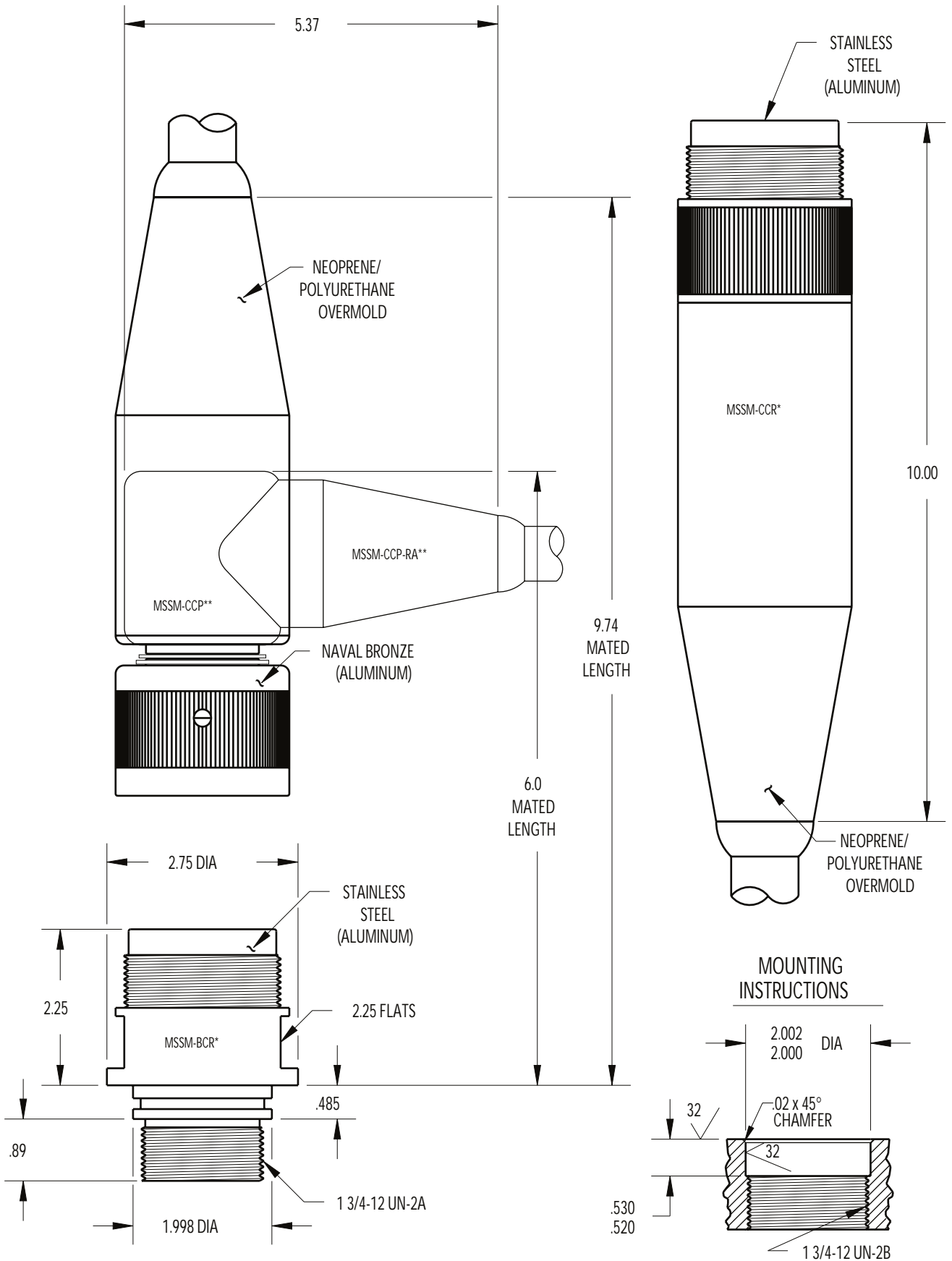

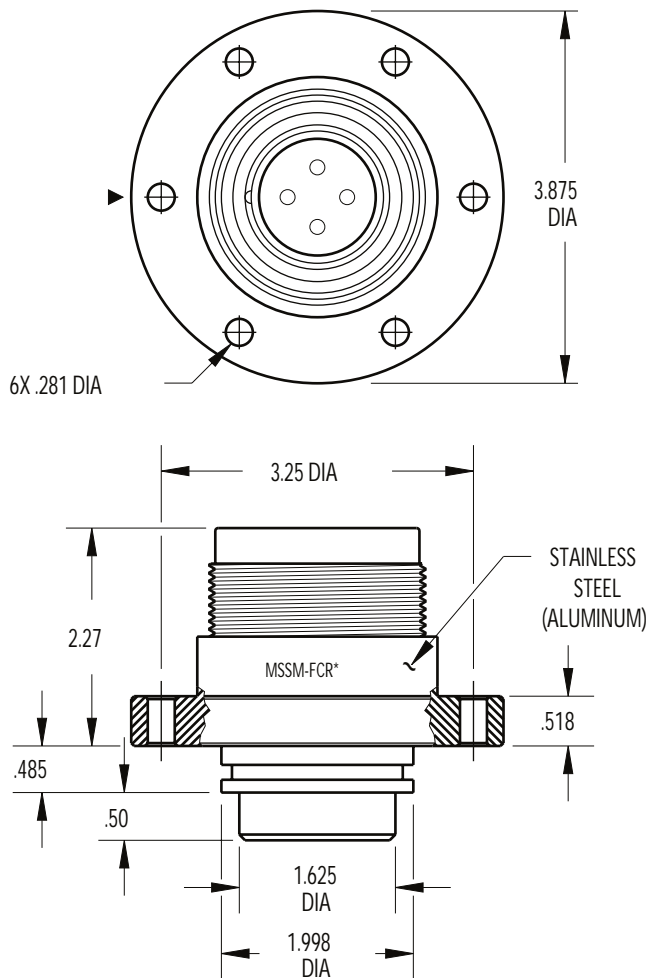

MOUNTING INSTRUCTIONS

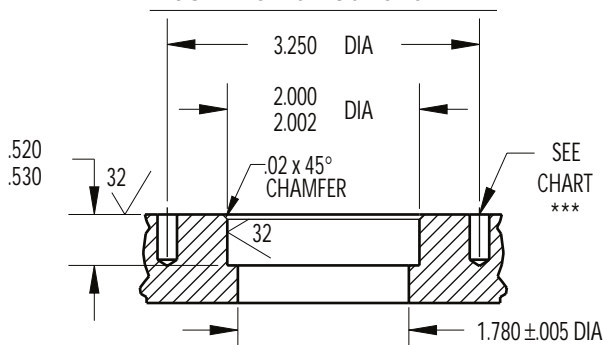

MOUNTING TORQUE FOR MSSM, MSAM-BCR	not to exceed 200 in/lbs	MATED PRESSURE RATING (psi)	20,000
DUMMY PLUG FOR MSSM-BCR/FCR/CCR	MSSM-SCP	DUMMY PLUG FOR MSSM-CCP	MSSM-SCR
DUMMY PLUG FOR MSAM-BCR/FCR/CCR	MSAM-SCP	DUMMY PLUG FOR MSAM-CCP	MSAM-SCR

NOTE: Delrin protective caps available upon request.

* See Technical Bulletin 45 71 for internal assembly and hardware specifications.

** See Technical Bulletin 45 72 for internal assembly and hardware specifications.

*** Blind tapped hole not to penetrate bulkhead, minimum full thread depth 2 times bolt diameter.

CONTACT
CONFIGURATION
(BCR FACE VIEWS)

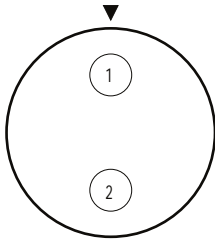

2#6 *

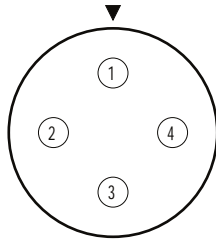

4#8 *

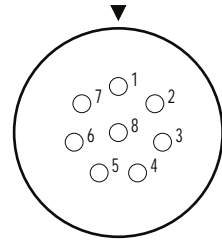

8#14

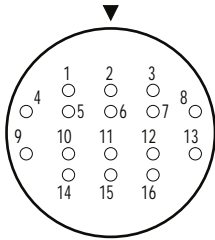

16#16

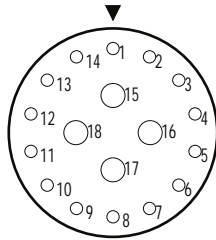

4#10
14#16

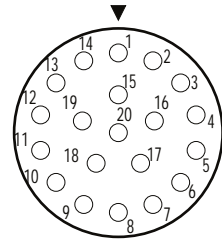

20#14

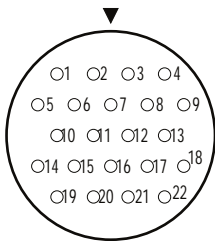

22#16

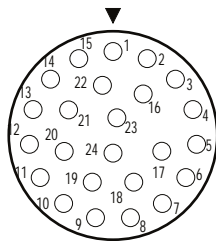

24#14

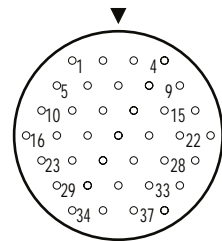

37#20

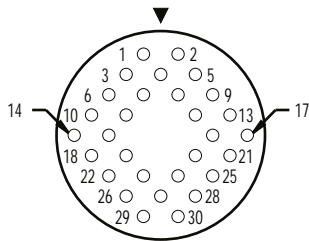

30#16

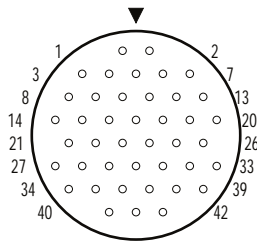

42#20

* Available in high voltage.

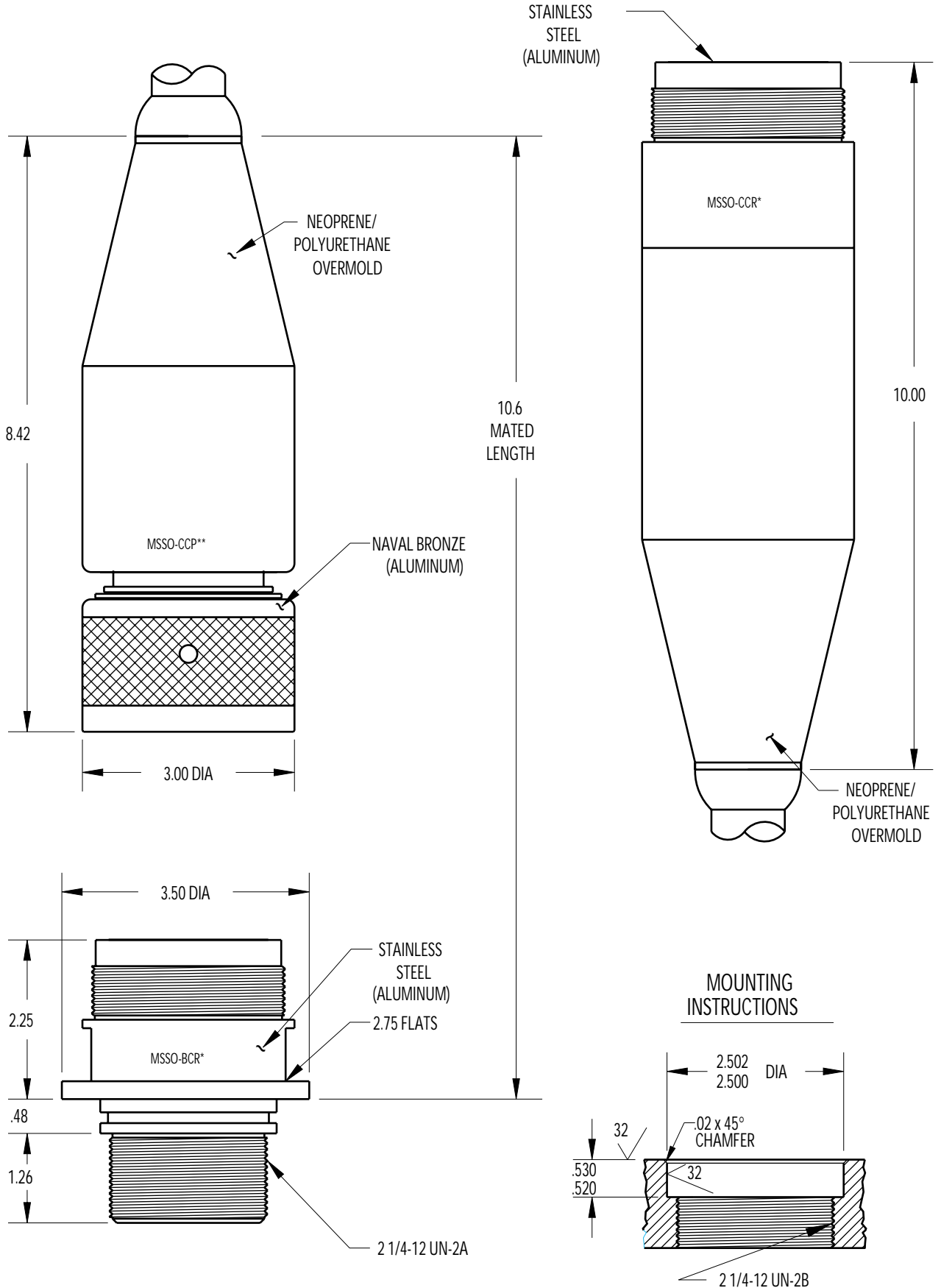

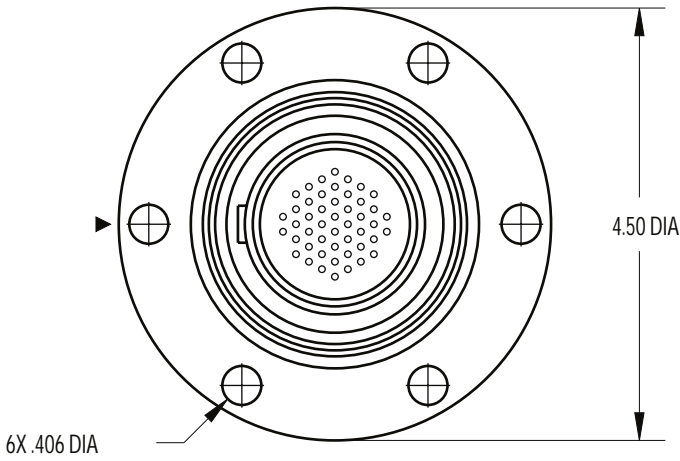

CONTACT
CONFIGURATION
(BCR FACE VIEWS)

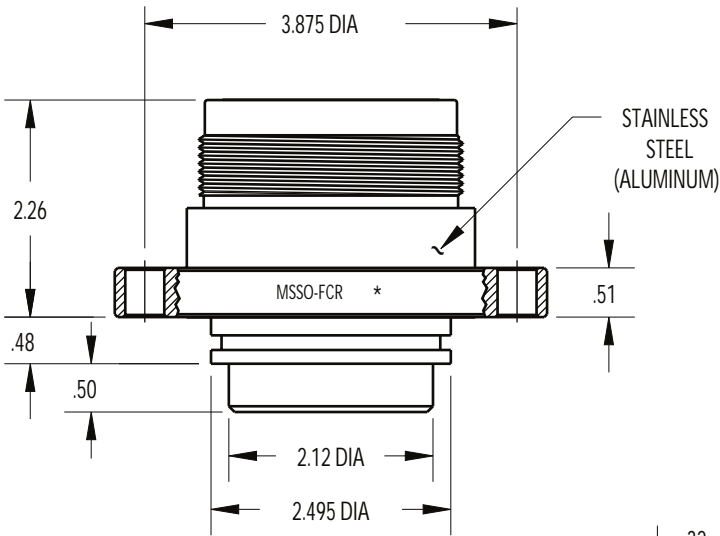
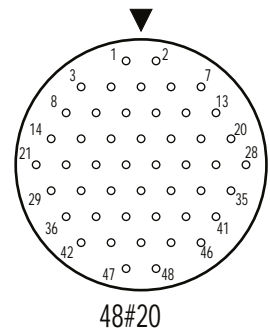
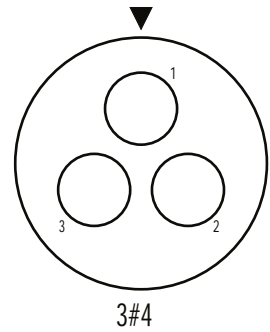

MOUNTING INSTRUCTIONS

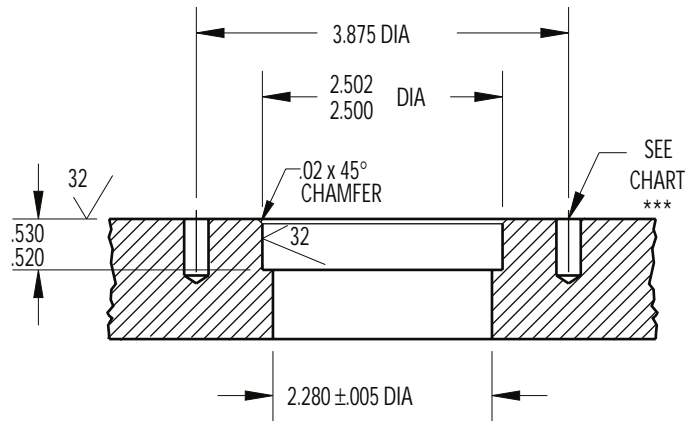

MOUNTING TORQUE FOR MSSO, MSAO-BCR	not to exceed 200 in/lbs	MATED PRESSURE RATING (psi)	20,000
DUMMY PLUG FOR MSSO-BCR/FCR/CCR	MSSO-SCP	DUMMY PLUG FOR MSSO-CCP	MSSO-SCR
DUMMY PLUG FOR MSAO-BCR/FCR/CCR	MSAO-SCP	DUMMY PLUG FOR MSAO-CCP	MSAO-SCR
NOTE: Delrin protective caps available upon request. * See Technical Bulletin 45 71 for internal assembly and hardware specifications. ** See Technical Bulletin 45 72 for internal assembly and hardware specifications. *** Blind tapped hole not to penetrate bulkhead, minimum full thread depth 2 times bolt diameter.			

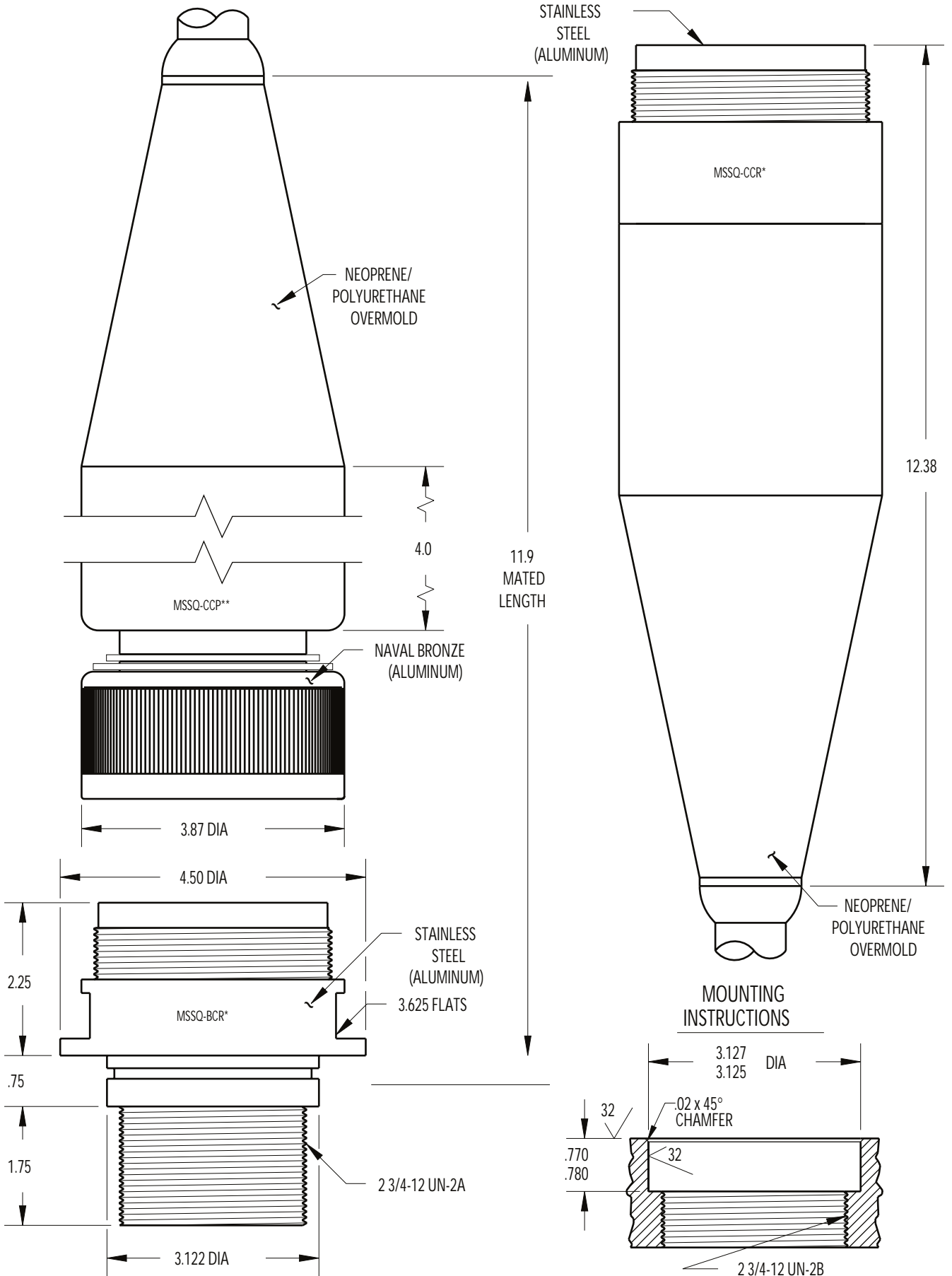

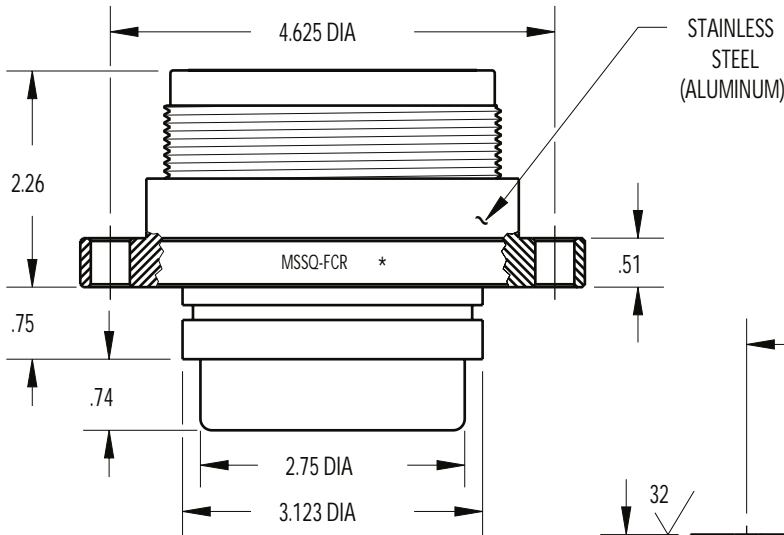
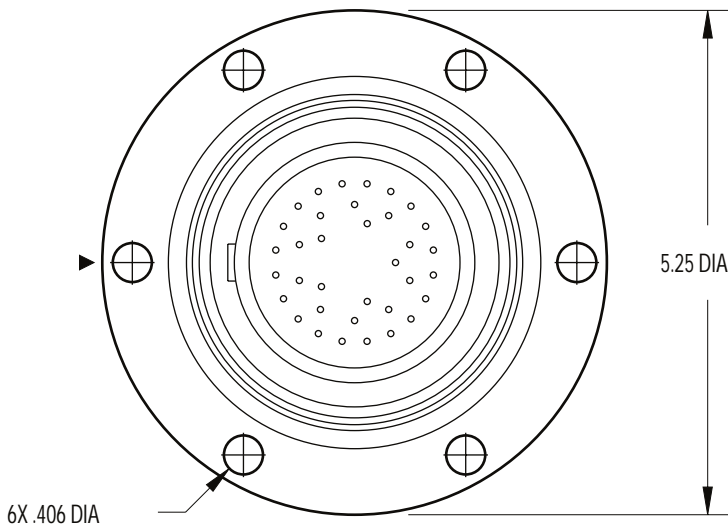

MOUNTING INSTRUCTIONS

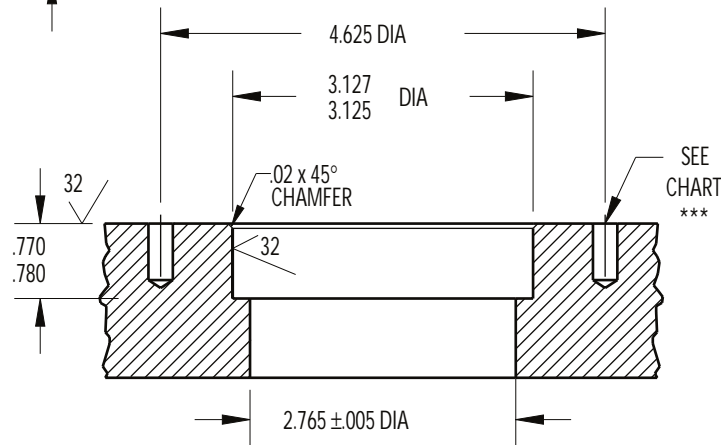

MOUNTING TORQUE FOR MSSQ, MSAQ-BCR	not to exceed 200 in/lbs	MATED PRESSURE RATING (psi)	20,000
DUMMY PLUG FOR MSSQ-BCR/FCR/CCR	MSSQ-SCP	DUMMY PLUG FOR MSSQ-CCP	MSSQ-SCR
DUMMY PLUG FOR MSAQ-BCR/FCR/CCR	MSAQ-SCP	DUMMY PLUG FOR MSAQ-CCP	MSAQ-SCR

NOTE: Delrin protective caps available upon request.
 * See Technical Bulletin 45 71 for internal assembly and hardware specifications.
 ** See Technical Bulletin 45 72 for internal assembly and hardware specifications.
 *** Blind tapped hole not to penetrate bulkhead, minimum full thread depth 2 times bolt diameter.

CONTACT
CONFIGURATION
(BCR FACE VIEWS)

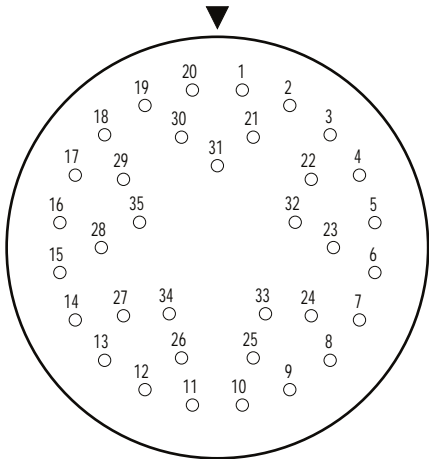

35#16
(High Voltage)

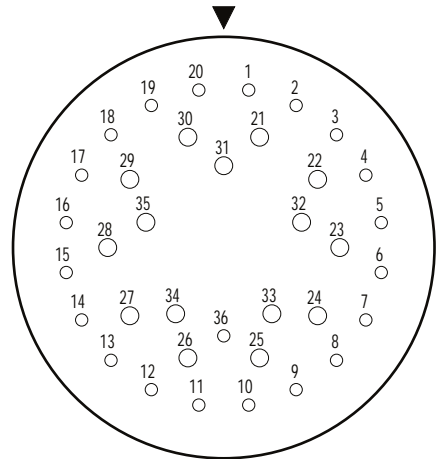

15#14
21#16
(High Voltage)

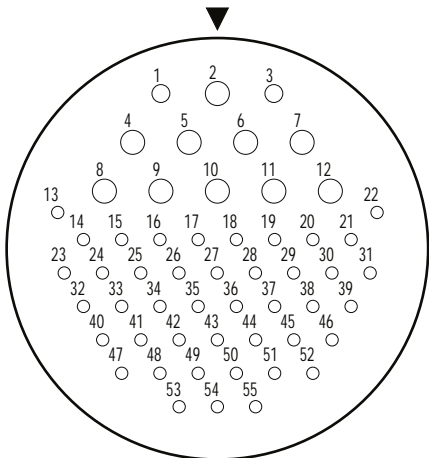

10#10
45#16

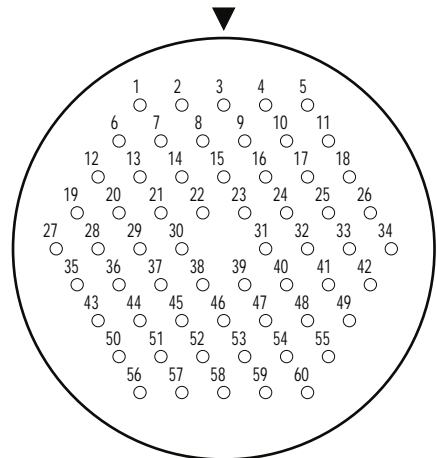

60#16

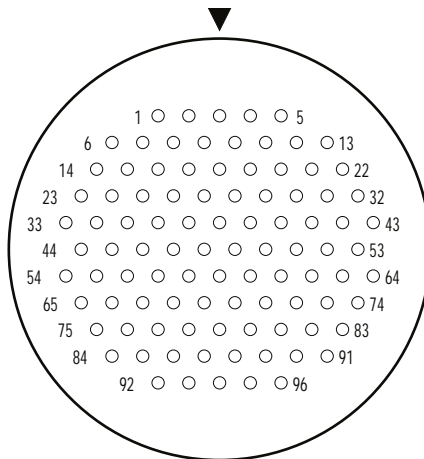

96#16

BCR/FCR/CCR DETAILED ASSEMBLY

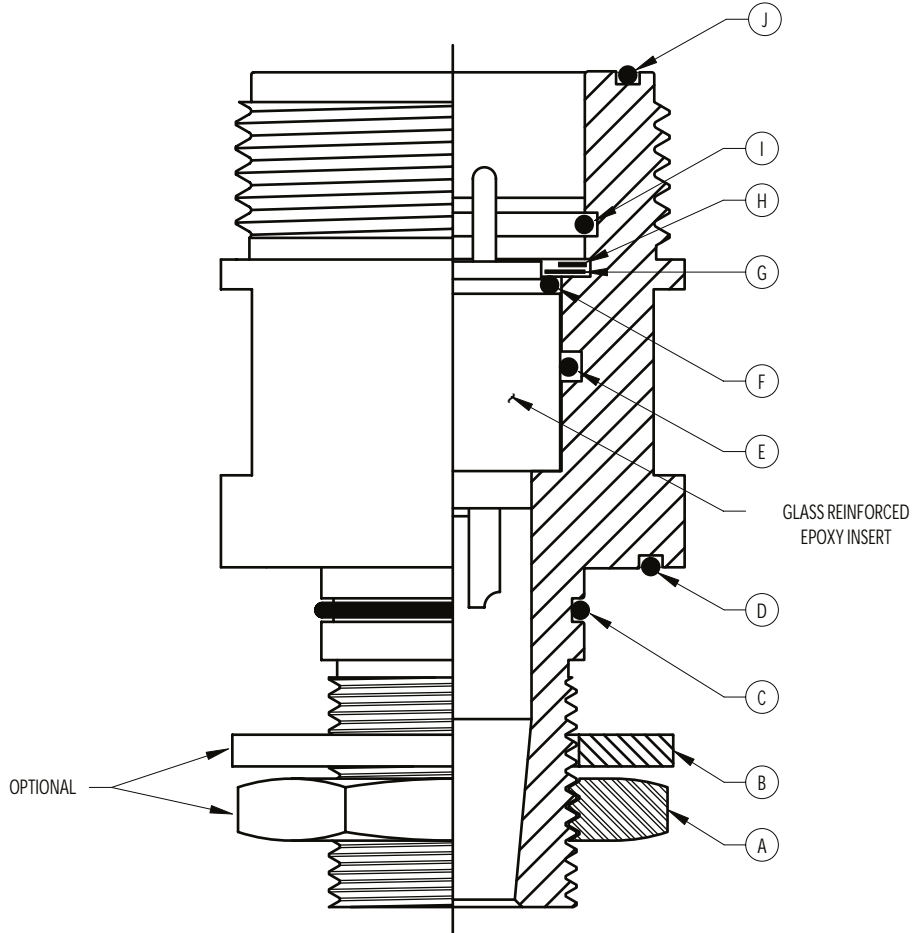

SCALE NONE

SHELL SIZE	G	K	L	M	O	Q
A BULKHEAD NUT *	35000 S 00	35000 S 01	35000 S 02	35000 S 03	35000 S 04	35000 S 06
B BULKHEAD WASHER *	35500 S 00	35500 S 01	35500 S 02	35500 S 03	35500 S 04	35500 S 06
C O-RING **	2-017	2-021	2-122	2-224	2-228	2-233
D O-RING **	2-023	2-029	2-131	2-142	2-234	2-241 ***
E O-RING	2-016	2-118	2-122	2-126	2-225	2-230
F O-RING	NONE	2-018	2-022	2-123	2-131	2-141
G INTERNAL WASHER	NONE	35000 S 21	35000 S 22	35000 S 23	35000 S 24	35000 S 26
H SPIROLOX RING	UR-62	UR-106	UR-131	UR-150	UR-187	UR-250
I O-RING	2-016	2-023	2-027	2-128	2-225	2-230
J O-RING	2-020	2-027	5-320	2-132	2-140	2-151

NOTE: See Technical Bulletin 45 10 for J size detailed assembly.

* Not required with FCR or CCR assemblies.

** Not required with CCR assembly.

*** FCR uses 2-240.

CCP DETAILED ASSEMBLY

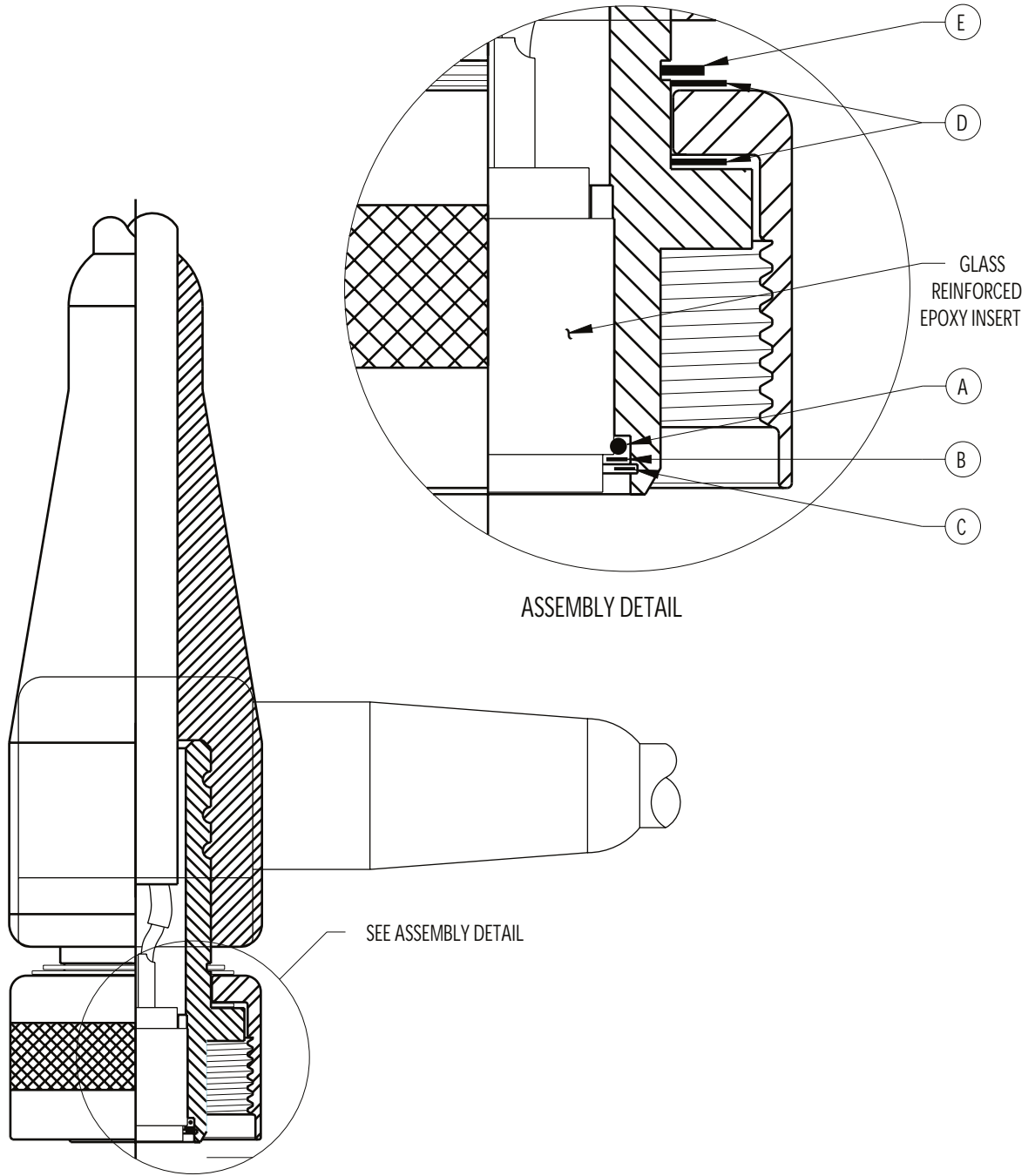

SCALE NONE

SHELL SIZE	G	K	L	M	O	Q
A O-RING	NONE	2-017	2-021	2-024	2-127	2-137
B WASHER	NONE	35000 S 31	35000 S 32	35000 S 33	35000 S 34	35000 S 36
C SPIROLOX RING	NONE	UR-87	UR-112	UR-137	UR-162	UR-225
D DELRIN WASHER (2X)	NONE	35000 P 11	35000 P 12	35000 P 13	35000 P 14	35000 P 16
E RETAINING RING	5100-87	5100-112	5100-137	5100-162	5100-212	5100-275

NOTE: See Technical Bulletin 45 10 for J size detailed assembly.

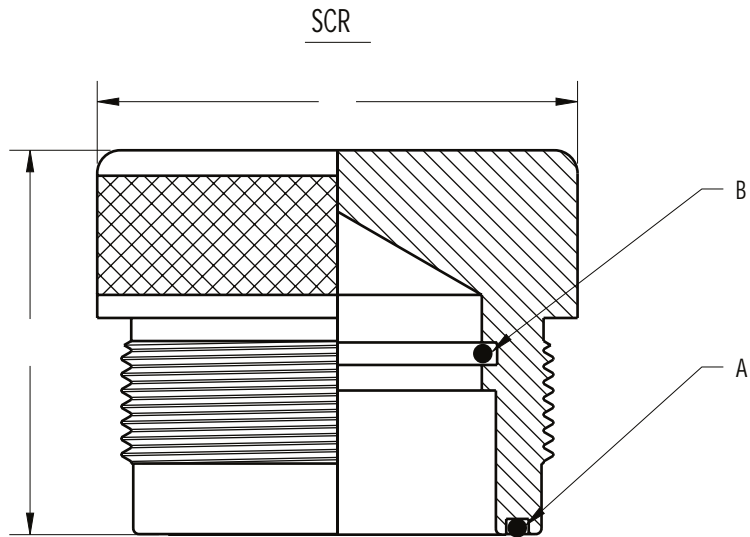
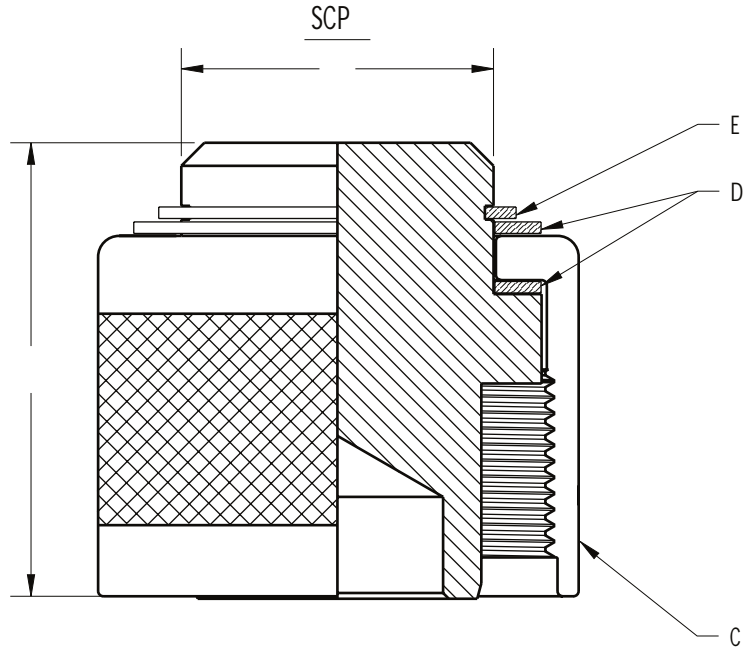

CONNECTOR SIZE	MSK	MSL	MSM	MSO	MSQ
A O-RING	2-027	5-320	2-132	2-140	2-151
B O-RING	2-023	2-027	2-128	2-225	2-230
C ENGAGING NUT	607406	607507	607606	607706	607917
D DELRIN WASHER (2X)	35000 P11	35000 P12	35000 P13	35000 P14	35000 P16
E RETAINING RING	5100-112	5100-137	5100-162	5100-212	5100-275
F DIA	1.11	1.38	1.62	2.12	2.75
G	1.56	1.56	2.37	2.37	2.37
H DIA	1.87	2.12	2.50	3.00	3.87
I	1.50	1.50	2.00	2.00	2.12
MATED PRESSURE RATING (psi)	20,000	20,000	20,000	20,000	20,000

SCALE NONE